

49th STREET

208'-8" F (63.61M)

144'-10" F (44.16M)

LANE

63'-8" F (19.4M)

208'-8" F (63.65M)

CRU'S  
AREA: 13,696.22 SQ. FT.

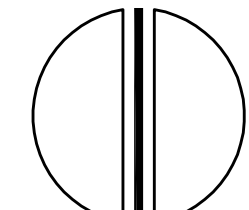
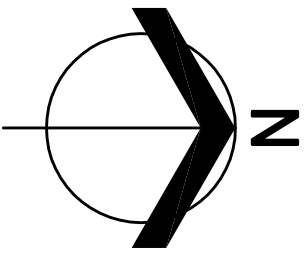

MAIN FLOOR PLAN  
SCALE : 3/32" = 1'-0"



50th AVENUE

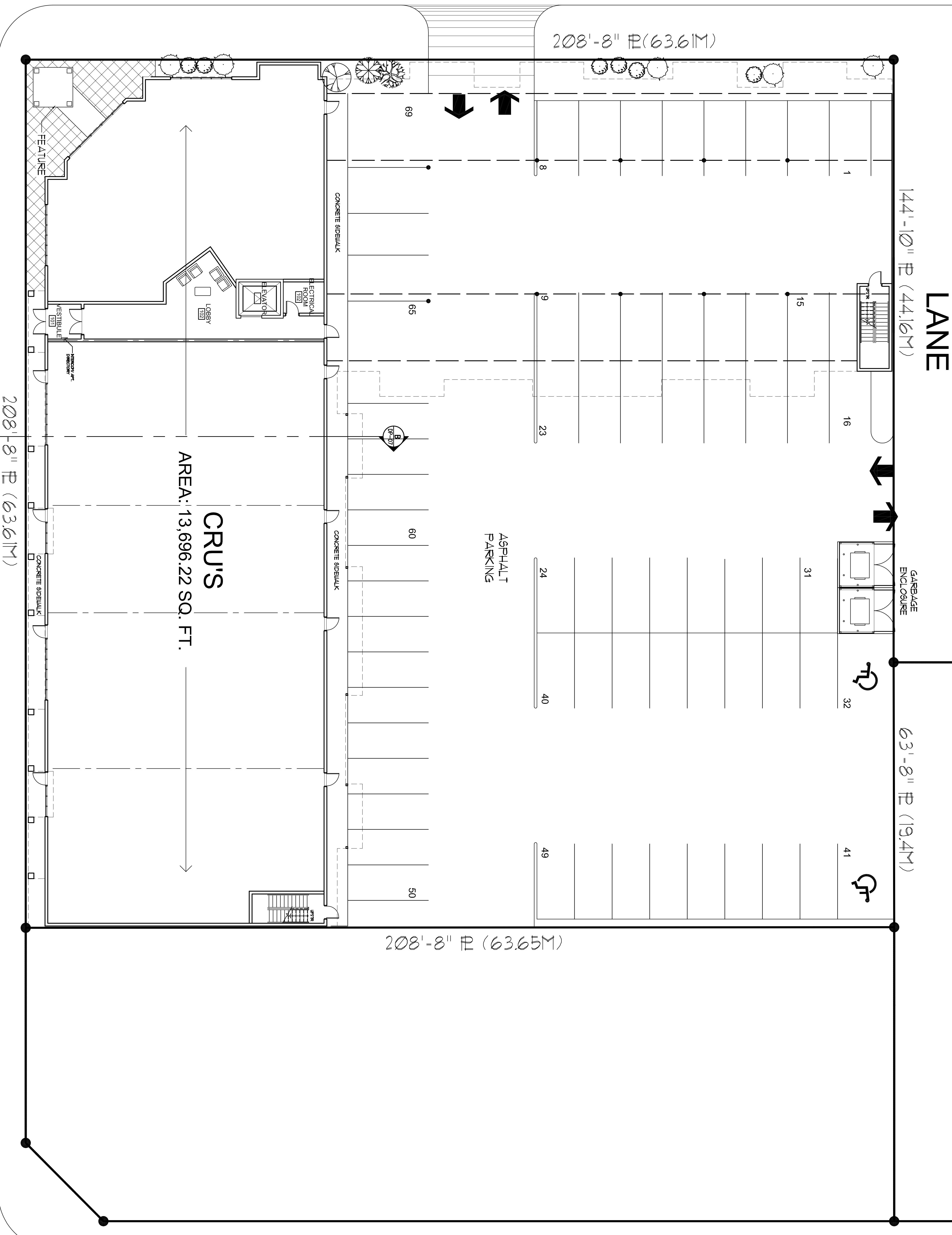

This drawing is the property of William H. Ross, Architect Inc. and shall not be reproduced, copied, or used in any way without the permission of the architect. The drawing MUST NOT be scaled. To the architect for measurement prior to construction.

no	date	revision
01	July 26, 07	Issued for Discussion
02	Aug 30, 07	Final Approval

email: whra@shaw.ca  
phone: (780) 482-3495  
fax: (780) 488-0725

proposed MULTI FUNCTION BUILDING GIBBONS, EDMONTON, AB.

Prepared for: P. RUSSELL / D. JUBINVILLE

WILLIAM ROSS ARCHITECT

FLOOR PLAN

Client: Corrie  
date: July 23, 2007  
scale: AS NOTED  
job #: 0110  
sheet: Dp-02  
of 1